

General recommendations:

- During the installation observe the compulsory security standards - wear protective gloves and work clothes with long sleeves.
- Protect against moisture, mechanical damage and adverse chemical factors.

STEP 1

Placing bentonite putty.

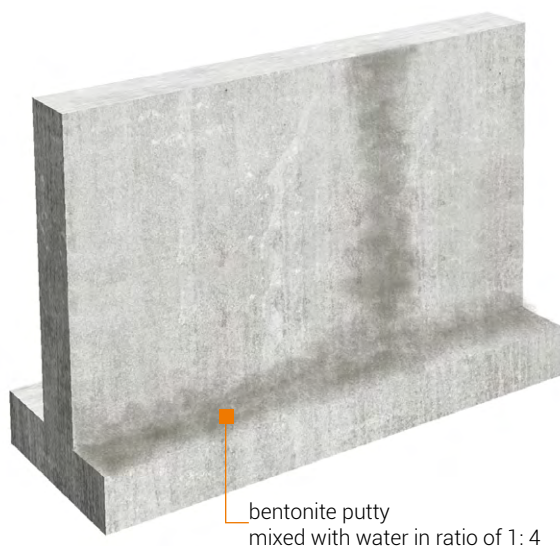

STEP 2

Putting steel sheets with bentonite.

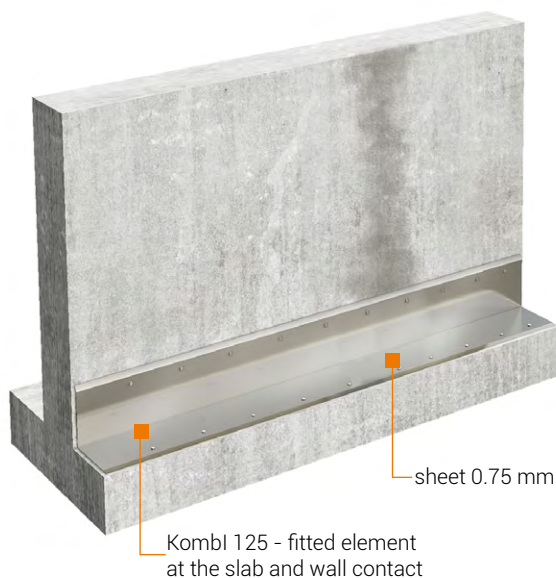

STEP 3

Installation of sheets using nails.

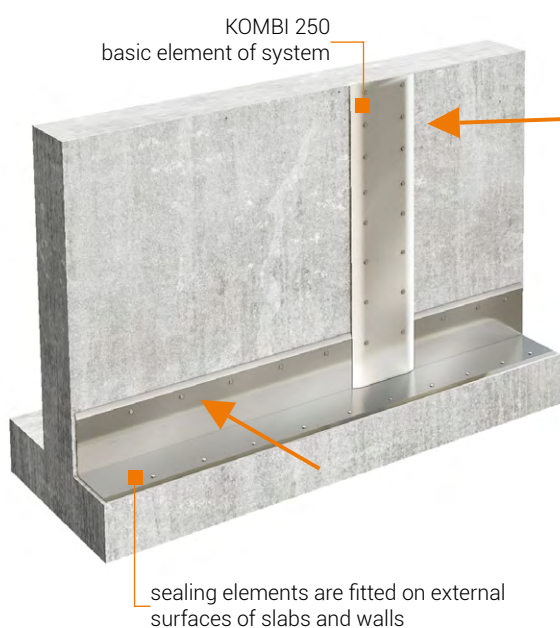

STEP 4

Installation of vertical sheets using nails.

